

# CT TECH CO., LTD

CT-LT-6-W-S

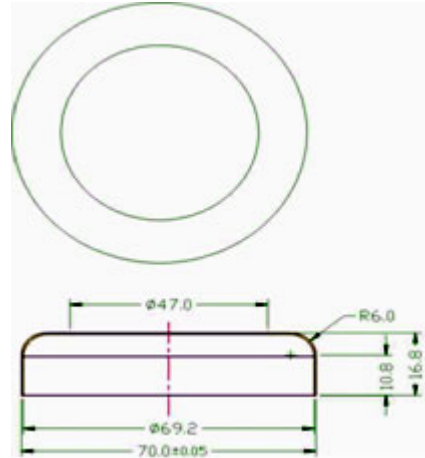

## LED Features

Item	Parameter range
LED Part No	EB-LT-6-W-S
LED Wavelength $\lambda$ d (nm) Or Tc (k)	7000-9000
LED Color	White

## Technical request

NO	Item	Units	Parameter range
1	Working environment	°C	-20~40
2	Storage condition	°C	-40~85
3	Work frequency	Hz	/
4	limited voltage	V	DC4.5 ± 10%
5	Input current	mA	50~100
6	Output power	W	0.2~0.5
7	Luminous flux	LM	13 ± 20%

## **Use manual:**

1. Take out product from packing box.
2. When you fix it ,uncover the film from the back of product,and then press lightly the product to the position you want ,where must be clean and dry.If not fix it ,don't uncover the film.
3. When you use it,just press lightly the transparent part of product to start operating.  
When press firstly, 3 LEDs inside are lighted,can be used in long-distance radiation.  
When press secondly,3 LEDs outside are lighted,can be used in large-angle lighting.  
When press thirdly,all 6 LEDs are lighted.  
When press forthly ,turn off.
4. When you change battery, wrest the lid to the direction of arrowhead ,open it,then change the battery,and lastly fix the back lid .
5. When you don't need to use it,make the foundation be in the closed state when the product almost don't dissipate power. so that it can be used above 2 years..

**Add: 7th Fl, No. 15, Lane 427, Fu Sing N. Rd., Taipei Zip code: 105**

**Tel: 886-2-25460395      Fax: 886-2-87707036**

**[www.cttechco.com](http://www.cttechco.com)      Email: [info@cttechco.com](mailto:info@cttechco.com)**